

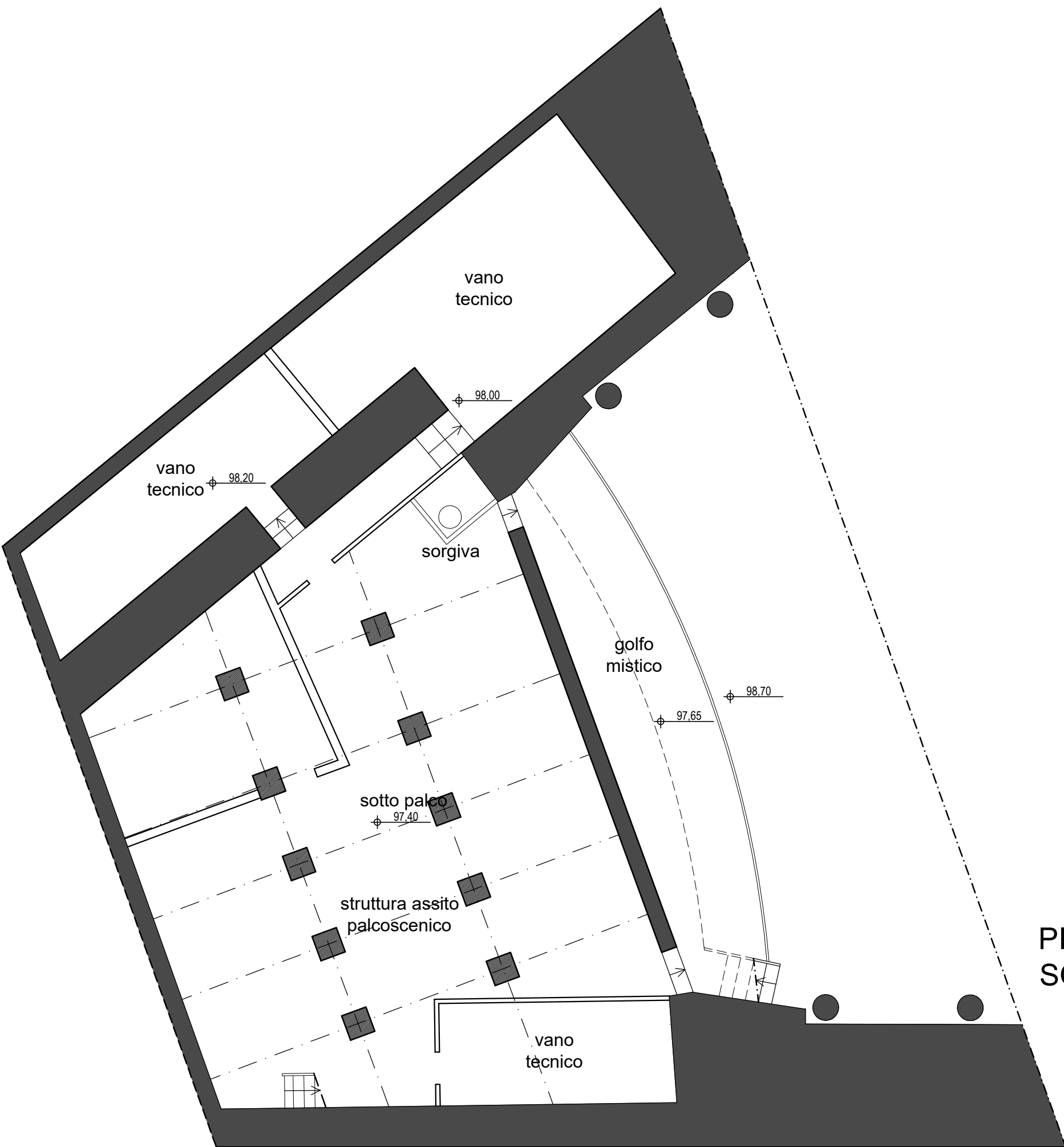

PIANTA
FOYER - PLATEA - PALCOSCENICO

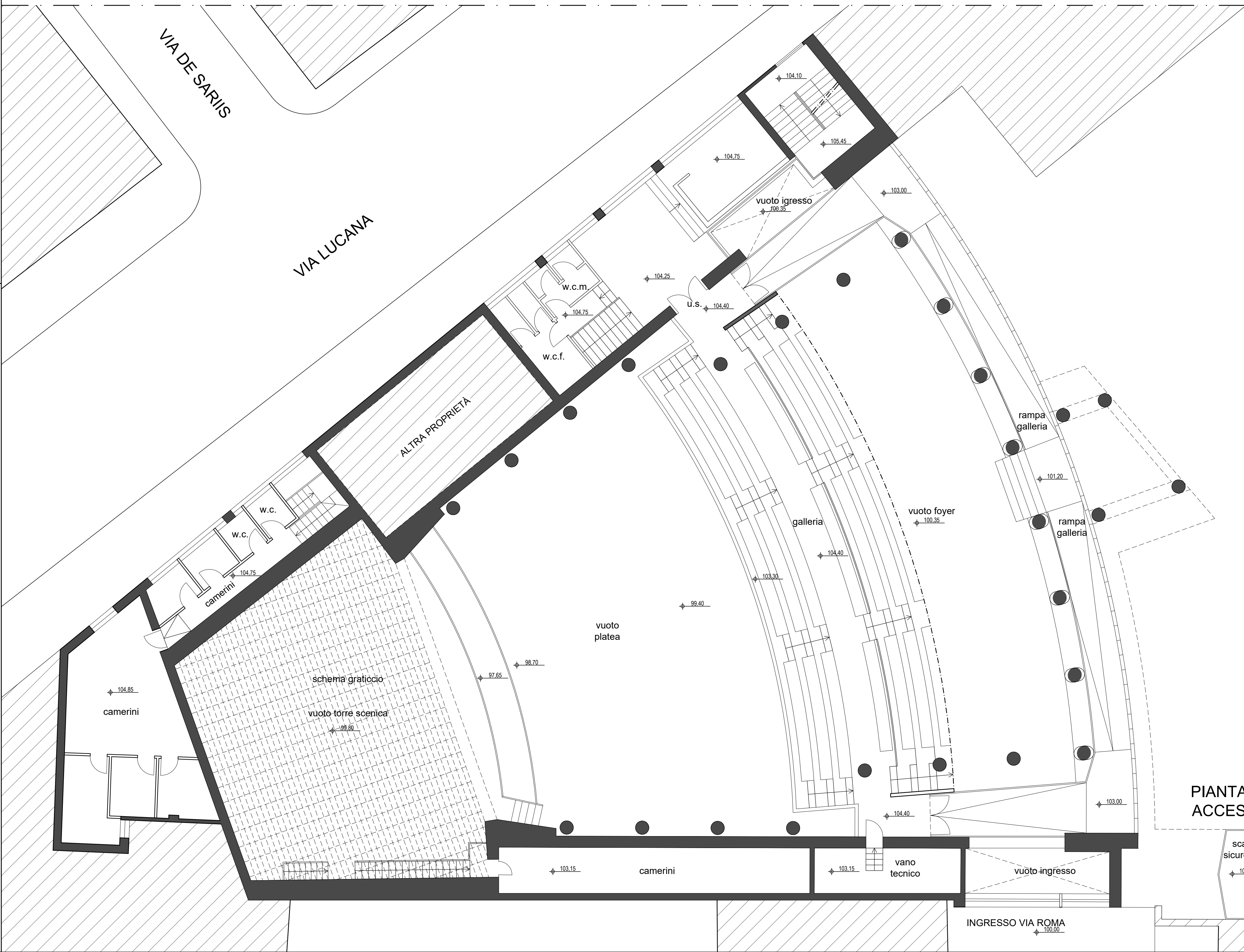

PIANTA
SOTTOPALCO



PIANTA
ACCESSO GALLERIA - CAMERINI

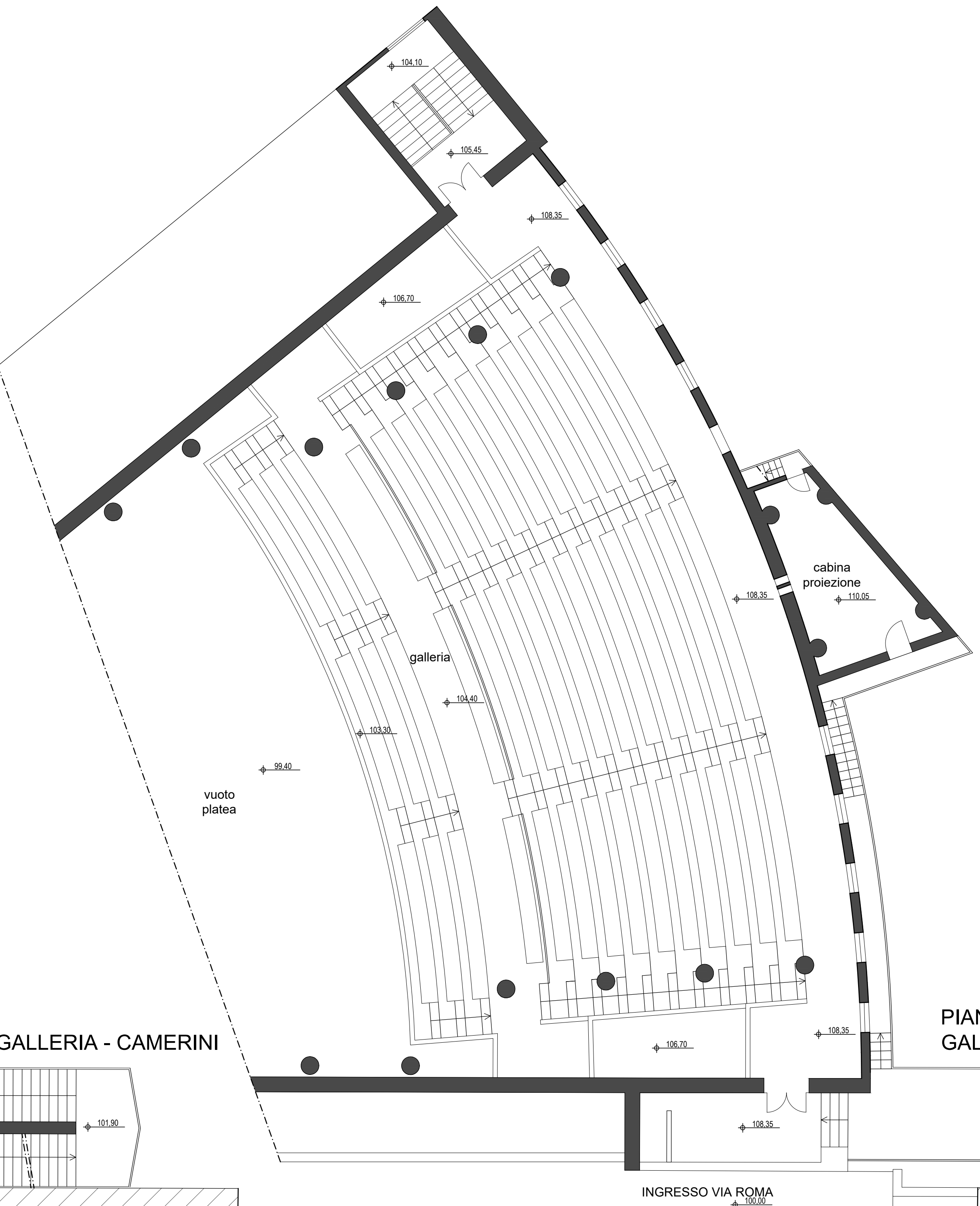

PIANTA
GALLERIA - CABINA PROIEZIONE

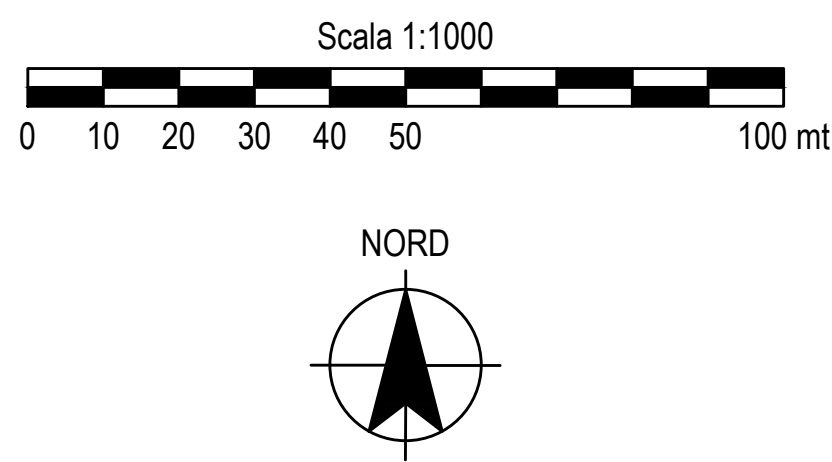

COMUNE DI MATERA
SETTORE OPERE PUBBLICHE

RESTAURO DEL TEATRO "DUNI"
PROGETTO PRELIMINARE

PROGETTISTI: Arch. Francesco Paolo GRAVINA					
R.U.P.: Ing. Biagio FERRARA					
TAVOLA	SCALA	DATA	AGGIORNAMENTI	ARCHIVO	DISegnATORE
1:100		Novembre 2020			
3	PIANTE TEATRO				